

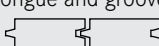

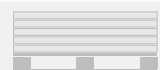
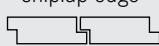

Wall 140

Plasterable insulation board for solid wood and brickwork outdoors

Cover size (m ² per board)	tongue and groove 	580 x 800 mm (0.46 m ²)	580 x 1250 mm (0.73 m ²)	580 x 1500 mm (0.87 m ²)	580 x 2000 mm (1.16 m ²)	
Thickness in mm	Price on request	m ² per palette	m ² per palette	m ² per palette	m ² per palette	Units per palette
60		18.56	29.00	34.80	46.40	40
80		13.92	21.75	26.10	34.80	30
100		11.14	17.40	20.88	27.84	24
120		9.28	14.50	17.40	23.20	20
140		7.42	11.60	13.92	18.56	16
160		6.50	10.15	12.18	16.24	14
180		5.57	8.70	10.44	13.92	12
200		5.57	8.70	10.44	13.92	12

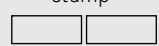
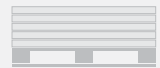
Cover size (m ² per board)	shiplap edge 	600 x 800 mm (0.48 m ²)	600 x 1250 mm (0.75 m ²)	600 x 1500 mm (0.90 m ²)	600 x 2000 mm (1.20 m ²)	
Thickness in mm	Price on request	m ² per palette	m ² per palette	m ² per palette	m ² per palette	Units per palette
60		19.20	30.00	36.00	48.00	40
80		14.40	22.50	27.00	36.00	30
100		11.52	18.00	21.60	28.80	24
120		9.60	15.00	18.00	24.00	20
140		7.68	12.00	14.40	19.20	16
160		6.72	10.50	12.60	16.80	14
180		5.76	9.00	10.80	14.40	12
200		5.76	9.00	10.80	14.40	12

Cover size (m ² per board)	stump 	600 x 800 mm (0.48 m ²)	600 x 1250 mm (0.75 m ²)	600 x 1500 mm (0.90 m ²)	600 x 2000 mm (1.20 m ²)	
Thickness in mm	Price on request	m ² per palette	m ² per palette	m ² per palette	m ² per palette	Units per palette
60		19.20	30.00	36.00	48.00	40
80		14.40	22.50	27.00	36.00	30
100		11.52	18.00	21.60	28.80	24
120		9.60	15.00	18.00	24.00	20
140		7.68	12.00	14.40	19.20	16
160		6.72	10.50	12.60	16.80	14

 Express programme – available at short notice  available to order

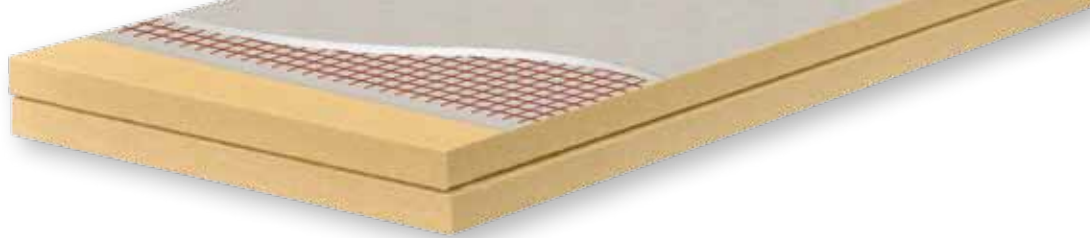

Product description

WALL 140 is a high pressure proof, plasterable wood fibre insulation board. It is to be fixed on solid wood or brickwork of exterior walls.

Nominal value of thermal conductivity λ_D : 0.040 W/(m·K)

Density: 140 kg/m³



Fields of application



Interior and exterior walls made of solid wood and brickwork

Plasterable

Download of technical datasheet at www.bischoff-schaefer.de



Characteristics of wood fibre insulation board Wall 140

General WDVS building inspectorate approval	Z-33.43-1368, Z-33.4-1366
German technical approval	DiBt Z-23.15 1828
Density	140 kg/m ³
Nominal value of thermal conductivity λ_D	0.040 W/(m·K)
Rated value of thermal conductivity λ	0.042 W/(m·K)
Reaction to fire according to DIN EN 13501	E
Building material class according to DIN4102	B2
Complete declaration	wood fibres, PMDI gluing, paraffin
Production method	dry process
Compressive resistance vertical to the plane of the plate	≥ 100 kPa
Tenacity vertical to the plane of the plate	≥ 20 kPa
Water vapour/diffusion resistance μ	3
Linear flow resistance	> 100 kPas/m ²
Short time water absorption	≤ 1.0 kg/m ²
Significant thermal capacity	2100 (J/kg K)
Waste code according to AVV	030105, 170201

